

## C6M (C6 main fan)

· 3 cables in total. Power supply connector / C65 connector / LED control connector



## C6S (C6 sub fan)

· 2 cables in total. Connector plug, both Female & Male. (Y-Type)

• Fan Size : 120 x 120 x 25mm • Fan Screw



## C6M (C6 MAIN FAN) |

### HOW TO CONNECT THE CABLES -----

- ① Connect the power supply cable.

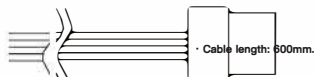

· Connect with 4pin power supply connector.

- ② Connect LED controller.

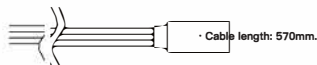

· Connect the reset button on the outer case, after connecting the cables, the reset button will be able to control LED effects.

- ③ C6S (Sub fans) connector

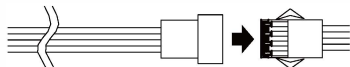

· Attached cable length: 120mm.  
· Connect the second fans with the main fan connector.

- ④ LED mode

• Use the reset button to control LED effects.

- RGB action mode
- Single color mode
- LED off mode
- Press the reset button for 3 seconds to turn off LED mode. (With the fans still running.)

※ The controller can only control LED mode, fan speed CAN'T be controlled with the controller.

## C6S (C6 SUB FAN) |

### HOW TO CONNECT THE CABLES -----

- ① C6S (Sub fans) connector

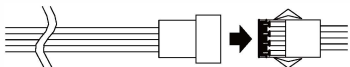

· Connector length: 600mm+ 120mm.  
· Female & male plugs can be used to extend the side and able to install multiple C6s fans.

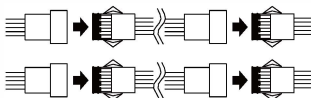

· C6S fans are able to extend through this connected cable, but excessive fans are not suggested.