

Baseus A3 Car Vacuum Cleaner User Manual

Please read the manual carefully before using the product and keep it with proper care for future reference.
Avoid the damage and danger from improper use.

1. Product Introduction

Product diagram-Introduction of buttons / description of indicator lights (Blue LED battery level indicator *3 + Red LED fault indicator *1)

Product configuration:



2. Product Parameters

Name: Baseus A3 Car Vacuum Cleaner
Model No.: CRKQ43
Input: 5V=2.1A
Rated power: 135W
Battery capacity: 4*2000mAh
Battery power: 28.8 Wh
Charging time: 3-5h
Noise: <75dB
Charging port: Type-C interface
Color: Silver/Tarnish
Charging protocol: Support QC3.0 fast charging
Size: 56.5*296mm
Weight: About 700g

3. Operating instructions

- 1) Power on to use: Press the power button to start the standard suction force level, press again to open the high suction force level, and press for the third time to turn off the cleaner.
- 2) Turn on the light: Long press the power button for 3 seconds to turn on the light, and long press again to turn it off.

4. FAQs

- 1) The product does not work.
Check whether the suction port is blocked. If so, it needs to be cleaned in time.
Due to the circuit protection design, when the temperature of the battery core is higher than 74 degrees, the product will turn off automatically.
- 2) The vacuum cleaner can not be charged.
You may not have connected the vacuum cleaner to the charger correctly. Please connect the vacuum cleaner to the charger with the charging cable.
You may not have plugged the adapter into the power outlet correctly, please plug the adapter into the power outlet.
Due to the circuit protection design in the product, when the temperature of the battery core is higher than 55 degrees, the charging time will be extended and the actual charging MOS will be turned off. You need to wait for the temperature to drop before charging normally.
- 3) The vacuum cleaner does not vacuum properly
The dust bin may not be installed correctly on the product. Please install the dust bin correctly on the vacuum cleaner.
The dust container may be full. Please empty the dust container.
The filter may be clogged. Clean the inner filter and the outer filter.

5. Clean and Maintenance

- Make sure to empty and clean the dust bin regularly, and do not leave debris in the dust bin for an extended period of time.
- 1) With the power off, turn the dust cup to remove the dust bin and pour out the dust and debris.
 - 2) Gently tip the filter to remove the dust attached.
 - 3) Gently wipe the dust cup with a dry cloth to clean.
 - 4) Clean the dust compartment filter with clean water; dry all parts completely, and then reassemble.

6. Cautions

- 1) Before cleaning the vacuum cleaner, be sure to unplug the adapter from the wall outlet.
- 2) Please use the charging cable included with this product to charge the vacuum cleaner. If you use the power adapter for charging, please purchase a matching power adapter that has obtained CCC certification and meets the standard requirements.
- 3) This product contains a built-in battery, please do not place this product near heat sources and exposed to fire sources.
- 4) This product contains a non-removable battery, please do not replace it by yourself to avoid damage to the battery and equipment.
- 5) This product is a conventional electronic product, please do not put this product in the fire sources, heat sources or direct exposed to fire sources.

7. Danger warning

- 1) Never breathe water or other liquids.
- 2) Never breathe flammable substances; nor breathe uncooled ash.
- 3) Never immerse the vacuum cleaner or charger in water or any other liquid.

8. The name and content of harmful substances in the product

Part Name	China RoHS controlled substances or elements					
	Pb	Hg	Cd	Cr (VI)	PBBs	PBOEs
Circuit	X	0	0	0	0	0
Switch	0	0	0	0	0	0
Power Cable	X	0	0	0	0	0
Motor Components	0	0	0	0	0	0
Rubber Components	0	0	0	0	0	0
Rubber Components	0	0	0	0	0	0
Rubber Components	0	0	0	0	0	0
Rubber Components	0	0	0	0	0	0
Rubber Components	0	0	0	0	0	0

This form is compiled in accordance with SJ/T 11364.

O: It indicates that the content of the toxic and harmful substance in all homogeneous elements of the component is below the limit specified in GB/T 26572 standard.

X: The content of toxic and harmful substances in at least one homogeneous material of this part exceeds the limit stipulated in GB/T 26572 standard.

The harmful substances contained in electronic and electrical products will not be leaked or mutated, and the period of normal use of the electronic and electrical products by the electronic and electrical users will not cause serious pollution to the environment or cause serious damage to people and property.

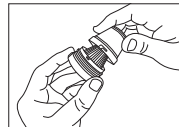

This equipment complies with the provisions of Directive 2012/19/EU and Directive 2006/66/EU. It is strictly forbidden to dispose of this equipment with ordinary trash; it should be recycled. This symbol indicates that the product shall not be treated as regular domestic trash, and must be delivered to a recycling center that is capable of recycling electronic and electrical equipment.
It is hereby declared that CRKQ43, a product model of Shenzhen Times Innovation Technology Co., Ltd., complies with the provisions of Directive 2014/53/EU, Directive 2011/65/EU. The full text of the CE Declaration of Conformity can be found on the following website: www.baseus.com

This device complies with part 15 of the FCC Rules. Operation is subject to the following two conditions: (1) this device may not cause harmful interference, and (2) this device must accept any interference received, including interference that may cause undesired operation. Any changes or modifications not expressly approved by the party responsible for compliance could void the user's authority to operate the equipment.

NOTE: This equipment has been tested and found to comply with the limits for a Class B digital device, pursuant to Part 15 of the FCC Rules. These limits are designed to provide reasonable protection against harmful interference in a residential installation. This equipment generates, uses and can radiate radio frequency energy and, if not installed and used in accordance with the instructions, may cause harmful interference to radio communications. However, there is no guarantee that interference will not occur in a particular installation.

If this equipment does cause harmful interference to radio or television reception, which can be determined by turning the equipment off and on, the user is encouraged to try to correct the interference by one or more of the following measures:

- Reorient or relocate the receiving antenna.
- Increase the separation between the equipment and receiver.
- Connect the equipment into an outlet on a circuit different from that to which the receiver is connected.
- Consult the dealer or an experienced radio/TV technician for help.

Manufacturer: Shenzhen Times Innovation Technology Co., Ltd.
Add: 5th Floor, Building B, Baseus Intelligence Park, No.2008, Xuegang Rd, Gangtuo Community, Bantian Street, Longgang District, Shenzhen Executive Standard: Q/SZCC 026-2018
Hotline: +86-400-0712-711 Website: www.baseus.com
PB3001Z/P0A1

Designed by Baseus
Made in China

The picture is only for reference.

