



VIOMI Cyber Pro User Manual

Please read this manual carefully before use and keep it properly.
This product shall be operated only in location at altitude below 2,000 meters.

Safety precautions

Please read the manual before use

Warning: In order to avoid any injury and unnecessary property loss to you and others, please carefully read and observe the following "Safety precautions" before use. Here, the safety precautions are divided into "Warning" and "Notice" for description. "Warning" and "Notice" are important contents for safe operation. Please observe them.



Warning : Precautions that may cause death or serious injury during the incorrect operation



Notice: Precautions that may cause minor injury or product damage during the incorrect operation



Warning

About the charger

1. This charger is only applicable to the designated vacuum cleaner;
2. Do not sprinkle any water on the body and charger or soak them in water;
3. Do not disassemble the power charger without permission to avoid fire or electric shock;
4. If the shell is damaged, do not use the charger to avoid the risk of electric shock;
5. The charger is only for indoor use. Do not expose it to the rain;
6. Before cleaning or maintaining the charger, please remove the charger from the socket;
7. Please unplug the charger from the power socket before cleaning and maintenance to avoid electric shock and injury;
8. If the wire is damaged, it must be replaced by the professional maintenance personnel to avoid any danger;
9. Do not attempt to charge a non-rechargeable battery with this charger;

About charging

1. Please check the following items before charging: ① Check whether the charger specification is consistent with the required power supply voltage; ② Please use the AC power supply with rated voltage. Do not use the generator or DC power supply to avoid fire and electric shock; ③ Please do not use a charger other than this product to charge the machine. Please use a dedicated charger to charge to avoid battery fault or extreme thermal effect;
2. Do not touch the charger or any live part of the product with wet hands to avoid electric shock;
3. Be sure to plug the charger completely to avoid electric shock, short circuit and fire;
4. During the charging or use, if the body is deformed or abnormally hot or produces any burning smell or abnormal noise during the operation, please cut off the power supply immediately, unplug the charger, and place the machine in an open place without combustibles to ensure safety so that the professional maintenance personnel replace or repair it to avoid any danger;
5. When unplugging the charger, be sure to hold the insulated part of the charger and do not pull the power cord;

About the use

1. This appliance can be used by children aged from 8 years and above and persons with reduced physical, sensory or mental capabilities or lack of experience and knowledge if they have been given supervision or instruction concerning use of the appliance in a safe way and understand the hazards involved.
2. Children shall not play with the appliance.
3. Cleaning and user maintenance shall not be made by children without supervision.
4. The appliance is only to be used with the unit provided.
5. This appliance contains batteries that are non-replaceable.
6. **WARNING:** For the purposes of recharging the battery, only use the detachable supply unit provided with this appliance.

Safety precautions

7. Do not wet the machine body, otherwise fire and electric shock may occur due to short circuit of the machine;
8. Do not use this product near or on the surface of flammable and explosive objects, which may cause fire and explosion;
9. This equipment is not suitable for children or people with no good physical and mental conditions, and people without experience and knowledge, which should be operated thereby under supervision;
10. Do not use this vacuum cleaner to absorb any detergent, kerosene, gasoline, alcohol, paint, perfume, etc., which may cause short circuit, fire or explosion of the machine;
11. Do not use this vacuum cleaner to absorb toner used in laser printer and g printer, otherwise it may result in fire or explosion;
12. Do not use this vacuum cleaner to suck any burning or smoking objects, such as soot that has not extinguished the heat source and burning cigarette butts or matches;
13. Do not place the airflow channel and moving part of the vacuum cleaner near long hair, loose clothes, fingers and other parts of the body;
14. Do not disassemble, repair or restructure it without permission to avoid fire, injury and poor operation, except for the replacement of consumables according to this manual;
15. In case of any abnormal fault, please cut off the power supply immediately and stop using it to avoid smoking, fire and electric shock;
16. In case of electric leakage or excessive motor temperature and abnormal sound during the use, such as body overheating, abnormal sound, peculiar smell, weak suction, etc., it should be stopped immediately and contact is made with the professional maintenance personnel;

Daily maintenance

1. If the machine is out of service for a long time, the power supply should be cut off immediately and the charger unplugged;
2. The battery is a sealed device, which produces no potential safety hazard under normal circumstances. In case of any liquid flowing out of the battery under extreme conditions, it may lead to irritation or burns. In case of accidental contact, please observe the following precautions:

- ① In case of skin contact - wash with soapy water; ② In case of eye contact - please immediately flush with water for at least 15 min and get medical attention;
3. Please regularly check the smoothness of the suction nozzle. If there is any blockage, please remove it in time to avoid the decrease of suction caused by the blockage and any impact on the performance of the machine;
4. After using the machine, please clean the dirty-water tank in time and keep the ventilation path unblocked, thereby avoiding suction drop and motor heating and any impact on the service life of the vacuum cleaner;
5. Please use a dry cloth to clean the dust on the charger regularly to avoid fire due to poor insulation and other reasons;
6. Be careful not to be scratched as the built-in knife of the complimentary cleaning brush contains blades;
7. If the machine is out of service for a long time, please make sure to charge it at least once a month to avoid any serious battery damage due to power shortage;
8. Please take the battery out before discarding the vacuum cleaner;
9. Before taking out the battery, be sure to cut off the power of the vacuum cleaner before operation; the removed battery should be properly placed;
10. Please turn off the power supply before cleaning the vacuum cleaner;

About the storage

1. Please keep the vacuum cleaner away from any electromagnetic equipment;
2. Keep the charger away from all heat sources;
3. Place the vacuum cleaner in a dry and cool place after use;

For this product, please contact the after-sales personnel if the machine breaks down. Do not repair it without permission to avoid danger; For transport and mailing, please be sure to drain the liquid in the clean-water tank and dirty-water tank, and wipe the clean-water tank to prevent the machine from being damaged by backflow;

Safety precautions

Notice

Use scope of the product

1. This product is applicable to hard floors in indoor environment, including waxed floors, stone floors, rubber floors, marble floors, granite floors, terrazzo floors, solid wood floors, composite floors, bamboo floors and various mirror cabinet, porcelain surfaces and other flat surfaces. If the machine is used on an uneven ground surface, the best performance may not be achieved;
2. Do not use this product near the working fireplace and heater to prevent the deformation of the machine shell;
3. Do not suck any high-temperature substances (unburnt cigarette butts, matches or hot ashes, etc.), ultra-fine substances (such as lime, cement, sawdust, stone powder and ash and carbon powder), hazardous substances (such as solvents, descaling agents, etc.), chemicals (such as acids, detergents, etc.) and other substances with uncertain physical characteristics;
4. Do not use this vacuum cleaner to suck any sharp objects, such as glass fragments, small toys, pins, paper clips, stones, gypsum, large pieces of paper, which may cause blockage and damage the machine;
5. Stains like shoe polish, paint, pigment, etc. with strong grease, strong viscosity or strong dyeability are not within the scope of application of this product;

About the machine

1. Do not disassemble the closed machine without permission as there are no parts in the machine that can be repaired by the customer, and do not try to change the performance of the machine, otherwise it may lead to danger;
2. Using a voltage that does not correspond to the specification of this product may damage the motor and more likely cause harm to the user;
3. When cleaning the stairs, extra careful should be taken to prevent falling;
4. Do not shake the machine up and down or collide violently to prevent any dirty water from flowing into the motor;

5. Please do not lift or carry the machine up and down, and do not place the machine sideways or horizontally to prevent any dirty water from entering the motor;
6. If the clean-water tank and dirty-water tank are not properly installed, do not use them;
7. Do not place any small objects at the air outlet, and do not block the air outlet. Remove the small objects that may hinder the smooth air flow at the air outlet to prevent the machine from overheating;

Product introduction

Main machine

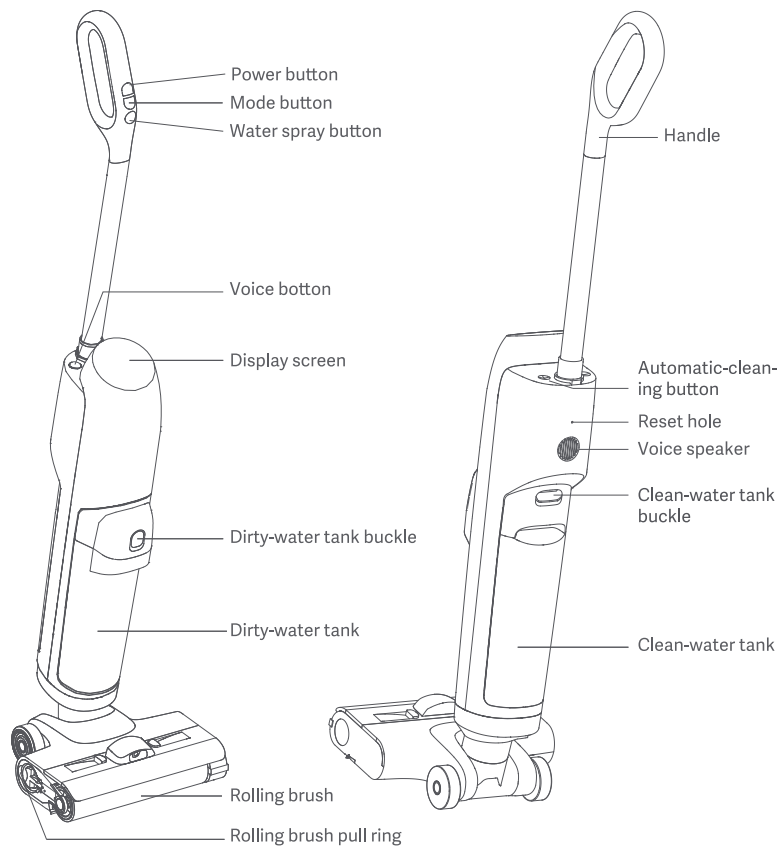

Charging base

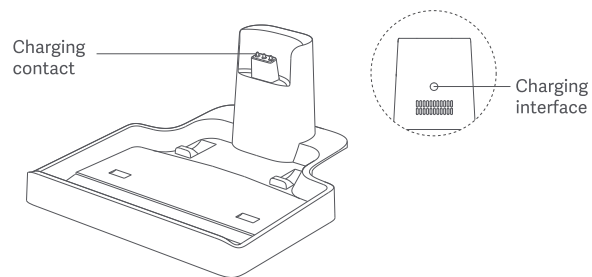

Accessories

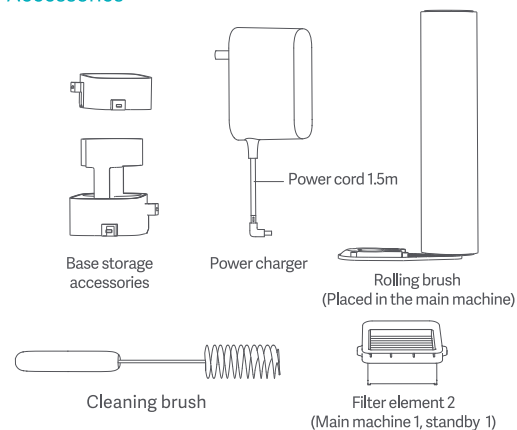

Product installation

Installation and disassembly of main machine

Installation: Insert the end of the handle into the interface of the vacuum cleaner's main machine along the vertical direction. After hearing the click sound and ensuring that the handle is tight without looseness, the installation is successful.

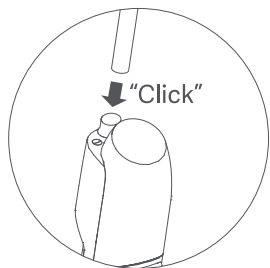

Disassembly: Use a hard object with a flat head to stretch into the hole on the back of the body to press the shell splinter, and pull out the machine handle upward at the same time;

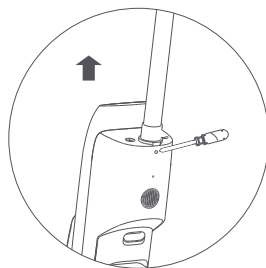

Installation of charging base

1. Press down the two accessories of the storage base along the buckle of the charging base until you hear the "click" sound, which means that the installation is successful;

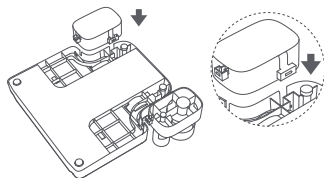

2. Connect the rear charging port of the charging base with the power charger, and then connect the power supply;

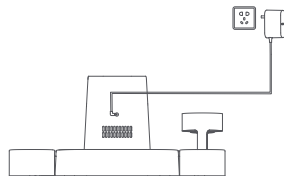

Warning

1. Do not let the children or pets approach or collide with the vacuum cleaner to avoid any injury;
2. Please do not install violently to avoid any unnecessary damage caused by any accidents;
3. Before installing any accessories and disassembling the clean-water tank and dirty-water tank, please cut off the power of the machine to avoid any danger;
4. When the dirty-water tank and clean-water tank are full of water, please be careful not to have your body injured by falling due to slipping hands during the disassembly.

Product use

On/off and mode switch

Click the power button to start the vacuum cleaner, and the intelligent mode is enabled by default at the start;

In the running state, click the switch button so that the suction will switch between intelligent mode, water suction mode and sterilization mode;



Intelligent mode



Water suction mode



Sterilization mode



Warning

1. Do not use the vacuum cleaner to absorb any foam liquid;
2. Do not tilt the machine by more than 140° to avoid any water leakage;
3. To prevent dirty water from flowing out, do not place the machine horizontally or shake it violently, so as to avoid any liquid backflow damaging internal components;

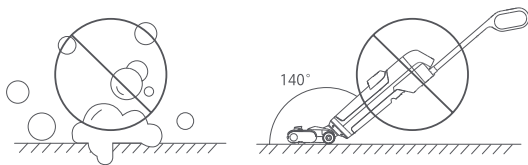

Air drying function



Power button

Mode button

1. After the automatic-cleaning is completed, the air drying process will be started automatically, and 3 hours are required for air drying;
2. Press the power button or mode button to manually stop the air drying process.

Use of charging base

Place the charging base on the horizontal ground, place the vacuum cleaner vertically on the charging base, and then power on to charge; During the charging, the fan will be automatically turned on to dry the rolling brush.

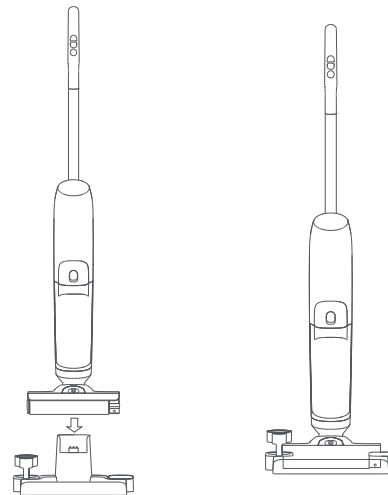

Warning

1. If the machine is out of service for a long time, please make sure to charge it at least once a month to avoid any serious battery damage due to power shortage;
2. If the vacuum cleaner is still being charged after the normal charging time, please stop charging immediately, otherwise there may be battery heating, deformation or extreme thermal effect;
3. If it is necessary to discard the vacuum cleaner, please remove the battery after disconnecting it;
4. The waste battery should be disposed of safely and properly, and may not be put into fire, water or soil;
5. If the waste battery leaks and touches the skin or clothing, please wash it with clean water to avoid any skin discomfort. If discomfort persists, get immediate medical attention.

Product use

Display screen function introduction

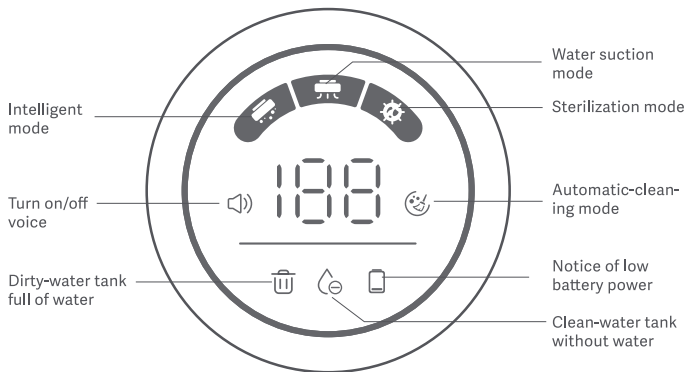

Use of automatic-cleaning function

Notice: The automatic-cleaning function must be performed when it is in the charged state and the power is greater than 25%. After the automatic-cleaning is completed, it is necessary to manually clean the internal dirt.

After finishing the cleaning, put the main machine back to the base in time to ensure that the water volume of the clean-water tank is sufficient. Short-press the automatic-cleaning button on the right side of the body so that the automatic-cleaning notice on the screen is lighted up to start automatic-cleaning. After the automatic-cleaning, the main machine continues to enter the charging state.

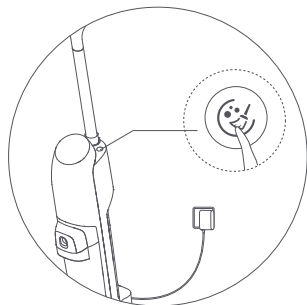

Reset and clear the user data

Reset: Press and hold the reset button with a tool for 1s to restore the vacuum cleaner to the factory setting.

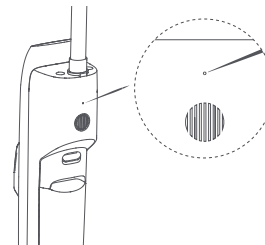

Disassembly and use of the clean-water tank

1. Press down the release buckle of the clean-water tank and pull it out to remove the clean-water tank;

2. Pull down to remove the plug at the water inlet of the clean-water tank;

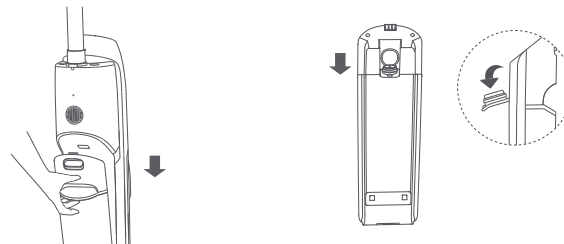

Product use

3. Align the water inlet of the clean-water tank with the water source and inject water to the water level.

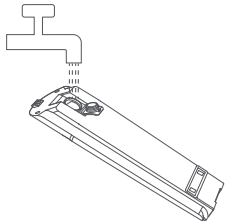

4. After closing the sealing cover of the water injection inlet, align the clean-water tank downward with the machine, and then press and hold the release buckle of the clean-water tank to push it inward until the "click" is heard to complete the installation;

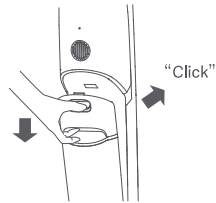

3. Pour out the dirty water;

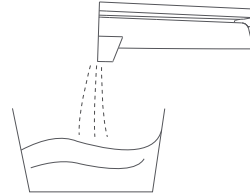

4. After installing the upper cover of the dirty-water tank back to its original position, align downward with the machine, then press and hold the buckle of the dirty-water tank to push it inward until the "click" sound is heard to complete the installation;

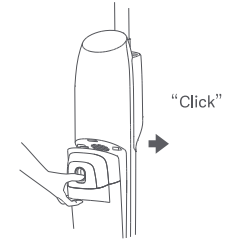

Disassembly and use of the dirty-water tank

1. Press down the buckle of the dirty-water tank and pull it out to remove the dirty-water tank;

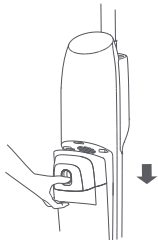

2. After removing the dirty-water tank, pull up the upper cover of the dirty-water tank;

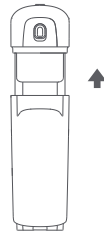

Product cleaning

Please turn off the vacuum cleaner before cleaning. If it is necessary to replace the parts, please use the specified parts to avoid any damage to the product.

Disassembly and cleaning of dirty-water tank and cleaning of dirt sensor

1. Press down the buckle of the dirty-water tank and pull it out to remove the dirty-water tank;

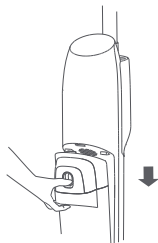

2. Gently wipe the dirt sensors on both sides of the machine body with a rag or wet paper towel;

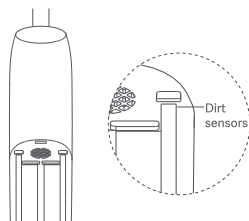

3. After removal of the dirty-water tank, take out the upper cover of the dirty-water tank upward and drain the dirty water, then take out the filter element upward and separate it from the upper cover of the dirty-water tank;

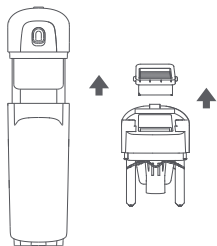

4. Clean the filter element and the upper cover of the dirty-water tank with clean water and install it back to the dirty-water tank;

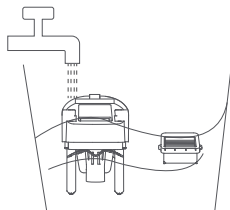

5. Use the complimentary cleaning brush to clean the pipe;

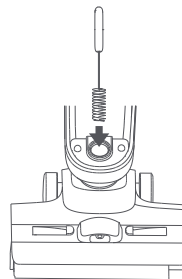

6. Clean the dirt sensors on both sides of the filter element with a rag or wet paper towel and install them back to their original positions;

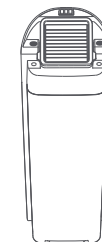

⚠ Notice

1. Pay attention to the storage of dirty water when disassembling the dirty-water tank to avoid any dirty water splashing during the disassembly;
2. The filter element should be used after safe air drying to avoid odor and decline of filtration performance;
3. When the upper cover of the dirty-water tank is installed back to its original position, make sure that the filter element has been installed;
4. Please clean the dirt sensor and light guide column in the machine on a regular basis to avoid any impact on the performance of the machine;

Product cleaning

Disassembly and cleaning of the rolling brush cover

1. Hold the buckle of the rolling brush cover plate with two fingers at the same time, press it gently, and then pull it up to open the cover plate;
2. After washing the cover plate with clean water, wipe the rolling brush cover plate with a wet cloth, and then install it back to its original position;

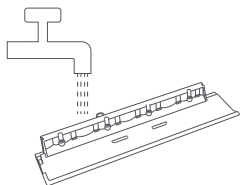
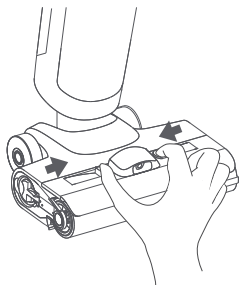

Notice

1. After the brush cover plate is washed with clean water, please wipe the water before installing it back to its original position to avoid the rolling brush working without protection;
2. In order not to affect the performance of the machine, it is recommended that you maintain its components on a regular basis;

Disassembly and cleaning of soft velvet rolling brush

1. Pull the rolling brush pull ring outward to directly pull the rolling brush;
2. Clean the rolling brush with clean water and install it back to its original position;

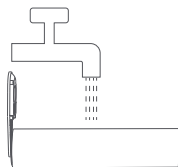
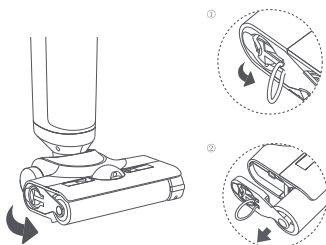

Basic parameters

Product name	Wet-Dry Vacuum Cleaner
Product model	VXXD05
Rated operating voltage	21.6V \approx
Lithium battery capacity	4000mAh/86.4Wh
Rated charging voltage	27.5V \approx
Net weight of product	About 4.7kg
Endurance time (Intelligent/water suction/sterilization mode)	About 40min/30min/40min
Rated power	250W
Product dimension	1197*272*256mm
Charging time	About 4h
Clean-water/ dirty-water tank capacity	740ml/740ml
Noise	\leq 78dB (A)

Troubleshooting

Fault phenomenon	Fault cause	Solutions
The floor brush does not work	The floor brush is wound with too many hair fibers and other long impurities	Clean the substances winding around the floor brush
	The soft velvet rolling brush is used on a unsuitable ground	Replace the soft velvet rolling brush or change the service environment
The motor does not rotate	Low battery capacity	Charge the vacuum cleaner
	The dirty-water tank is full of dirty water	Clean the dirty-water tank
	The service time is too long and the temperature is too high	Restart after standing for cooling
Weakened suction of vacuum cleaner	Low battery capacity	Use after full charge
	Clogged suction nozzle	Clean the foreign matters from the suction nozzle
	The rolling brush is wound by hair and other objects	Clean the rolling brush
	Incorrect installation of rolling brush and dirty-water tank	Reinstall
	The dirty-water tank has reached the specified capacity	Clean the dirty-water tank
The product cannot be charged	The main machine and charger interface are not well connected	Reconnect after inspection
No water comes out of the rolling brush	The clean-water tank short of water	Add water to the clean-water tank
	The clean-water tank is not installed properly	Reinstall the clean-water tank
The automatic-cleaning does not work	The rolling brush may be stuck by large particles	Open the rolling brush cover plate for inspection
	The machine is not charged	Ensure that the automatic-cleaning function is restarted when the main machine is in the charging state
	The power of the machine is less than 20% and the automatic-cleaning cannot be started	Restart the automatic-cleaning function in the charging state
	The dirty-water tank is not installed in place/the dirty-water tank is full	Reinstall or clean the dirty-water tank
	The clean-water tank is not installed in place/the clean-water tank short of water	Reinstall or add water to the clean-water tank