

RK ROYAL KLUDGE

USER MANUAL

Mechanical Wireless Keyboard

English
Русский
中文繁體

166-87201-05

PRODUCT BASIC English

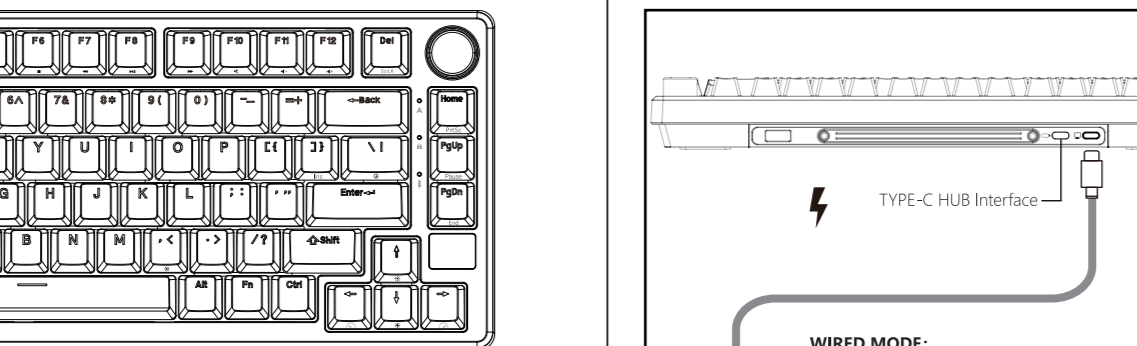

keyboard

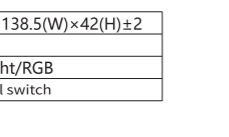
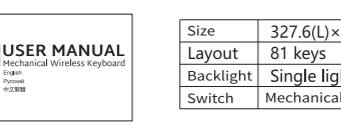

Size	327.6(L)×138.5(W)×42(H)±2
Layout	81 keys
Backlight	Single light/RGB
Switch	Mechanical switch

WIRED MODE/INDICATOR LIGHTS English

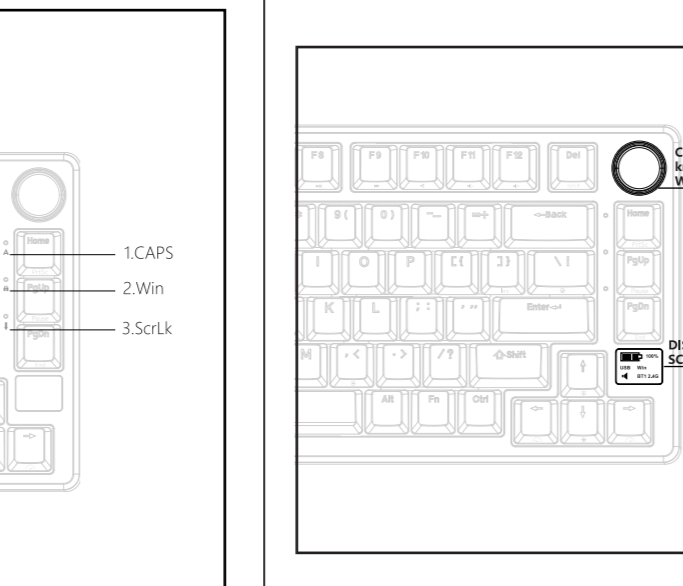

WIRED MODE:
Connect the USB to the device and select the USB mode with the knob.

Recommend: Using 5V 1A Rated power to charge keyboard

DISPLAY SCREEN/CLICKABLE KNOB SWITCH English

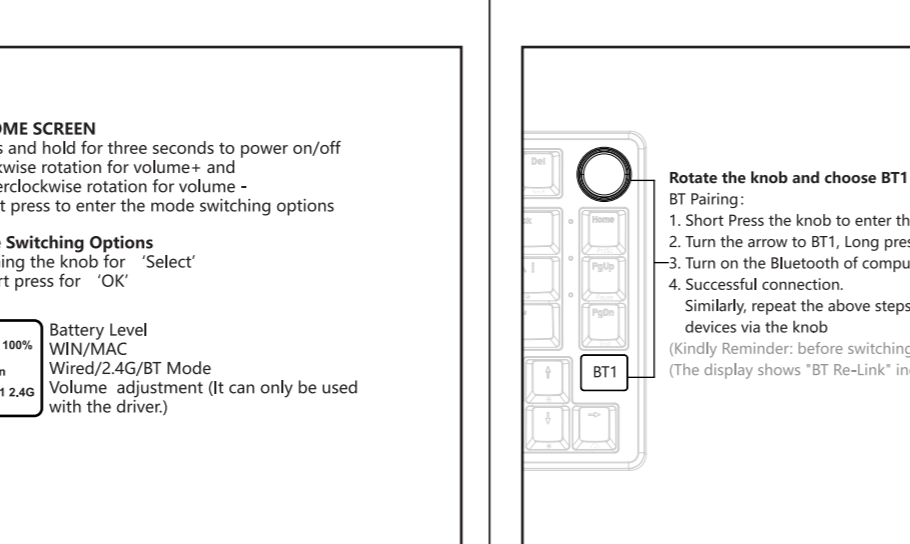

AT HOME SCREEN
1. Press and hold for three seconds to power on/off
2. clockwise rotation for volume+ and counterclockwise rotation for volume -
3. Short press to enter the mode switching options

Mode Switching Options
1. Turning the knob for 'Select'
2. Short press for 'OK'

Battery Level
WIN/MAC
Wired/2.4G/BT Mode
Volume adjustment (It can only be used with the driver.)

BT CONNECTION English

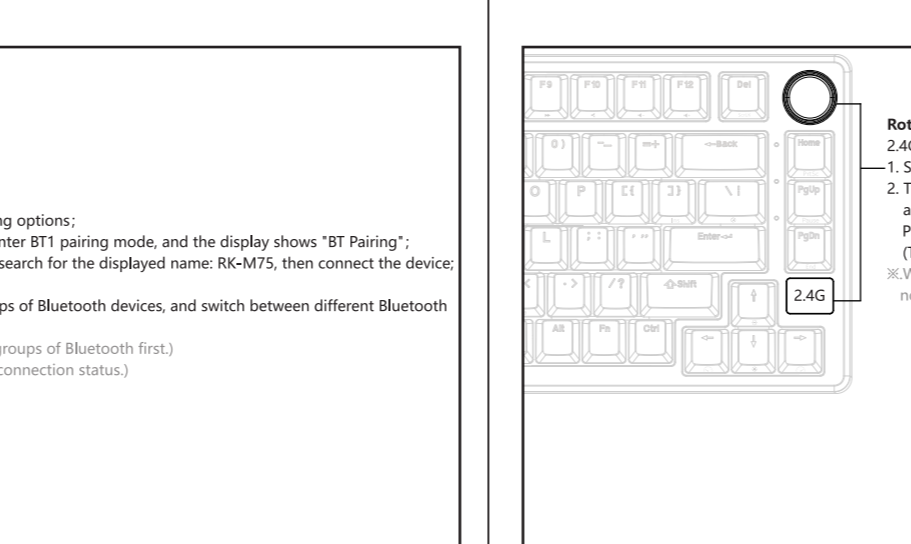

Rotate the knob and choose BT1 mode
BT Pairing:
1. Short Press the knob to enter the mode switching options;
2. Turn the arrow to BT1, Long press the knob to enter BT1 pairing mode, and the display shows "BT Pairing";
3. Turn on the Bluetooth of computer/phone, and search for the displayed name: RK-M75, then connect the device;
4. Successful connection.

Similarly, repeat the above steps to store 3 groups of Bluetooth devices, and switch between different Bluetooth devices via the knob
(Kindly Reminder: before switching, please pair 3 groups of Bluetooth first.)
(The display shows "BT Re-Link" indicating the BT connection status.)

2.4GHZ WIRELESS English

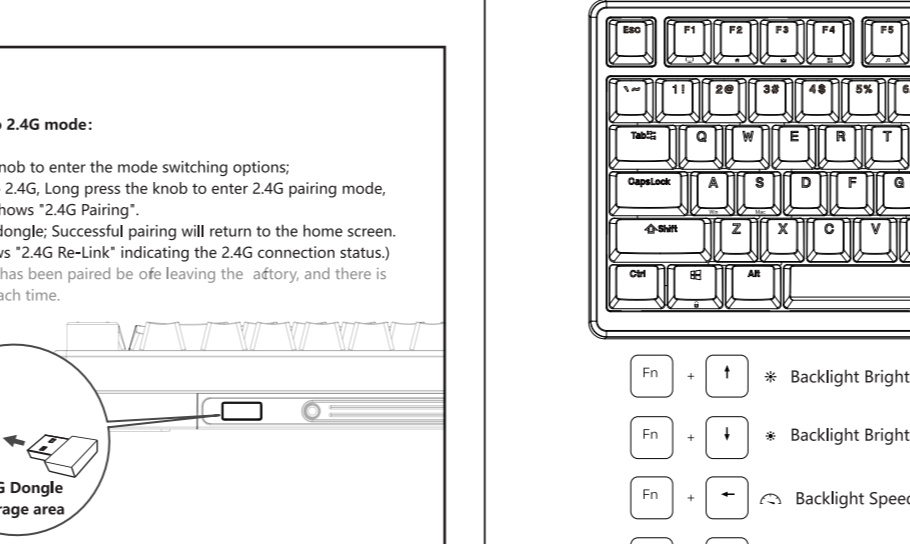

Rotate the knob to 2.4G mode:
2.4G Pairing:
1. Short Press the knob to enter the mode switching options;
2. Turn the arrow to 2.4G, Long press the knob to enter 2.4G pairing mode, and the display shows "2.4G Pairing";
3. Plug in the 2.4G dongle, Successful pairing will return to the home screen.
(The display shows "2.4G Re-Link" indicating the 2.4G connection status.)
※Warm prompt: It has been paired before leaving the factory, and there is no need to pair each time.

BACKLIGHT CONTROL English

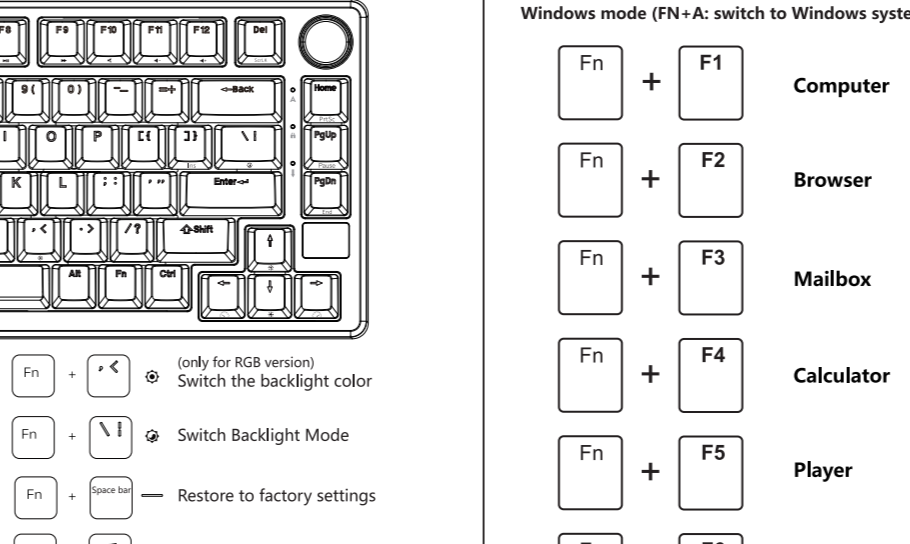

Fn + ↑ * Backlight Brightness+
Fn + ↓ * Backlight Brightness-
Fn + ← Backlight Speed -
Fn + → Backlight Speed+

Fn + ← (only for RGB version) Switch the backlight color
Fn + ↓ Switch Backlight Mode

Fn + [Space bar] Restore to factory settings
Fn + [Esc] window lock

MULTIMEDIA KEYS FOR WINDOWS English

Windows mode (FN+A: switch to Windows system)

Fn + F1	Computer	Fn + F7	Last song
Fn + F2	Browser	Fn + F8	Play / pause
Fn + F3	Mailbox	Fn + F9	Next song
Fn + F4	Calculator	Fn + F10	Mute
Fn + F5	Player	Fn + F11	Volume-
Fn + F6	Stop	Fn + F12	Volume+

MULTIMEDIA KEYS FOR MAC English

MAC mode (FN+S: switch to MAC system)

F1	Screen Brightness-	F8	Play / pause
F2	Screen Brightness+	F9	Next song
F5	Keyboard Backlight Brightness-	F10	Mute
F6	Keyboard Backlight Brightness+	F11	Volume-
F7	Last song	F12	Volume+

SECONDARY COMBINATION FUNCTION KEYS English

Fn + Del	ScrLk	Fn + PgDn	End
Fn + Home	PrtSc	Fn +]	Ins
Fn + PgUp	Pause		
Fn + A	switch to windows system		
Fn + S	switch to mac system		

Download Driver Address: www.rkgaming.com/download/1

SYSTEM REQUIREMENTS English

- BT Mode**
- Device With Bluetooth 5.1 or later
 - PC: Windows 7 or Later
 - Mac: macOS X 10.6 Snow Leopard or Later
 - iOS: All iPads/iPhone 5 or Later
 - Android: 5.0 Lollipop or Later
- Wired/2.4Ghz Mode**
- Computer With Available USB port
 - PC: Windows 7 or Later
 - Mac: macOS X 10.6 Snow Leopard or Later